

# Data sheet series 330 Quick release couplings

**Design** with spiral serration for higher speeds

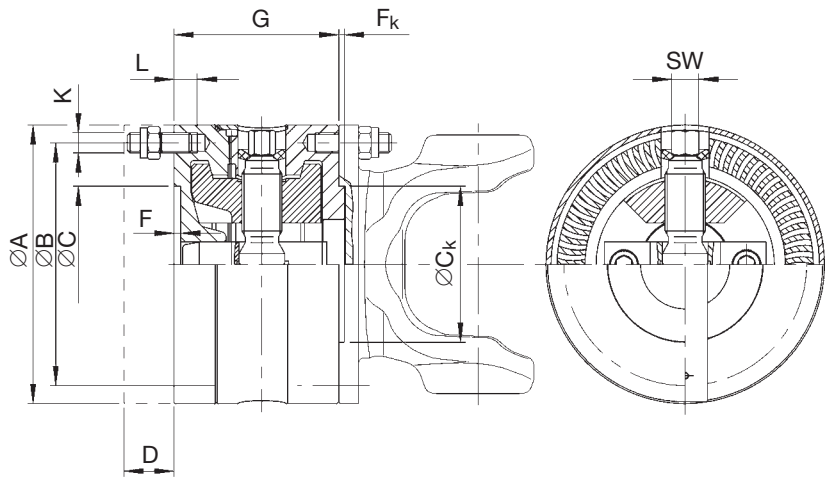

Connection for series 687/688  
 Connection for series 587  
 Connection for series 392  
 with face key

For hole distribution, see data sheets of the corresponding driveshaft.

Coupling size			330.10	330.20	330.30	330.40	330.50			330.55		
Shaft connection			687/688.15	687/688.20	687/688.25 687/688.35	687/688.30 687/688.40	687/688.40 687/688.45	687/688.45 687/688.55 687/688.65	587.50	392.50	587.55	392.55
Model		Nr.	000	003	003	003		000		001	000	001
	A	mm	100	130	150	180		225		225	250	250
	B	mm	84	101,5	130	155,5		196		196	218	218
	C <sup>1)</sup>	mm	57	75	90	110		140		105	140	105
	C <sub>k</sub> <sup>11)</sup>	mm	57	75	90	110		140		105	140	105
	D <sup>2)</sup>	mm	20	38	40	40		45		45	45	45
	F	mm	2,5	2,5	3,5	4		5		5	6	6
	F <sub>k</sub>	mm	2,3-0,2	2,3-0,15	2,3-0,2	2,3-0,15		4-0,2		4-0,2	5-0,2	5-0,2
	G	mm	76	100	100	112		144		144	148	162
	j <sup>3)</sup>	-	6	8	8	8		8		8	8	8
	K <sup>4)</sup>	-	M 8 x 18	M 10 x 22	M 12 x 25	M 14 x 28		M 16 x 35		M 16 x 40	M 18 x 40	M 18 x 45
	L <sup>10)</sup>	mm	10	11	14	20		18		18	21	21
	G <sub>k</sub> <sup>12)</sup>	kg	4,7	7,5	10,6	16,4		34		36	40	49
Ta Nut		Nm	35	69	120	190		295		295	405	405
Extension <sup>5)</sup>		Nr.	2.365/13 M	2.365/17 M	2.365/19 M	22 M		24 R		24 R	27 R	27 R
Ta Spindle		Nm	30	45	80	100		190		190	220	220
Socket wrench <sup>6)</sup>		Nr.	1/2" D 19 SW 13		1/2" D 19 SW 17			1/2" D 19 SW 22				

## Operating instructions

### Engaging and disengaging the coupling

Engaging and disengaging are done by operating the threaded spindle located in the inner part of the coupling. The spindle can be reached from two sides and be operated. The spindle is tightened by means of a socket wrench (see table).

#### Notice:

1. Before engaging the coupling, make sure that the coupling teeth are properly fitted.

2. The engagement direction is marked by arrows. The spindle may be tightened either clockwise or counter-clockwise.

3. The joint with the coupling component falls back when disengaged. **Caution: Danger of injury!**

In case of a subsequent installation of the quick release coupling, the driveshaft must be correspondingly shorter. The threaded spindles of the coupling are lubricated by the supplier with MoS<sub>2</sub>. Relubrication is recommended from time to time.