

BC3... / BC06... MODULAR COMPONENTS

BC308 INTERMEDIATE BASE PLATE FOR XQ3... (P → A)

- BC** Module base
- 3** CETOP 3/NG6
- 08** Base plate for XQ3 (P→A)
- 00** No variant
- 1** Serial No.

Weight: 1,5 Kg

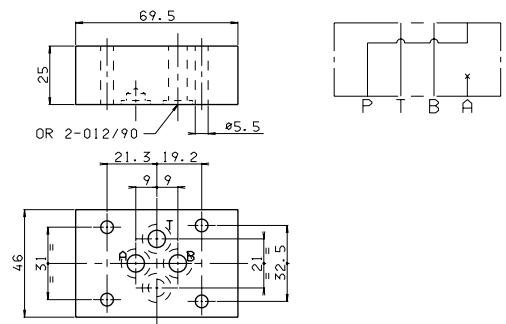

BC309 INTERMEDIATE BASE PLATE FOR XQ3... (B → P)

- BC** Module base
- 3** CETOP 3/NG6
- 09** Base plate for XQ3 (B→P)
- 00** No variant
- 1** Serial No.

Weight: 1,4 Kg

• To take advantage of this base it is necessary to operate with the pump at connector A of the multi station base plate

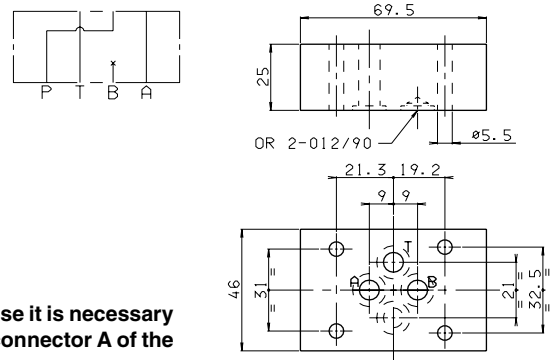

BC06XQ3 BASE PLATE FOR PROPORTIONAL VALVE TYPE XQ3...

- BC** Module base
- 06** CETOP 3/NG6
- XQ3** base plate XQ3
- 00** No variant
- 1** Serial No.

Weight: 1,4 Kg

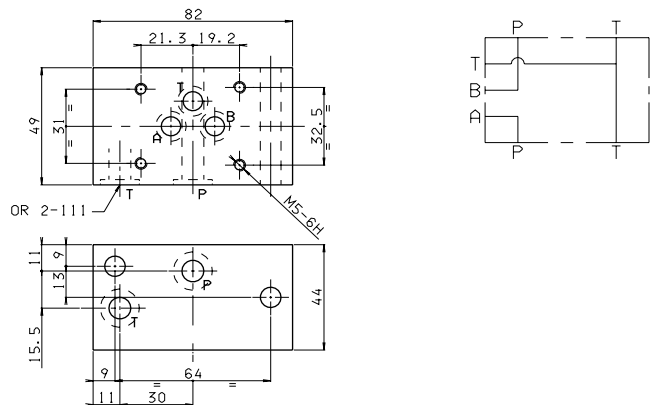

BC06XQP3 BASE PLATE FOR PROPORTIONAL REGULATOR TYPE XQP3...

- BC** Module base
- 06** CETOP 3/NG6
- XQP3** Base for XQP3 proportional regulator
- 00** No variant
- 1** Serial No

Weight: 1,4 Kg

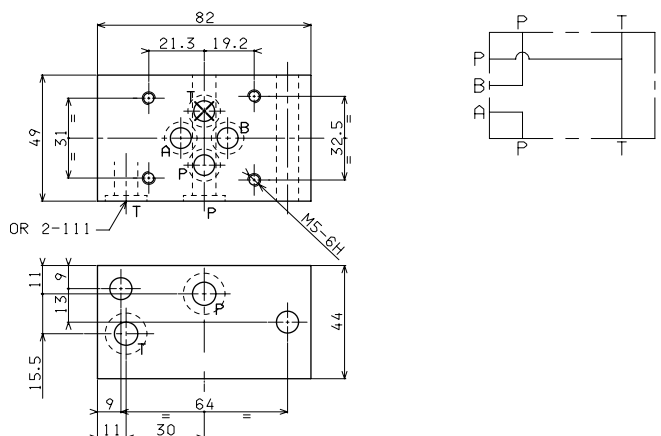

7